



42,089 SF  
GROCER ANCHOR  
AVAILABLE

2,040 SF  
AVAILABLE

2,040 SF  
AVAILABLE

2,040 SF  
AVAILABLE

2,560 SF  
Available

6,000 SF  
Available  
(Divisible)

SPRING ST

PALO VERDE AVE

# LAKWOOD PLAZA MARKETPLACE

NWC SPRING ST. & PALO VERDE AVE

## 2,040 - 42,089 SF

GROCER | FITNESS | MEDICAL | RETAIL | RESTAURANT AVAILABLE

Please Contact

**JASON GORDON**

310.451.8171 X222  
JGORDON@EPSTEEN.COM

BRE LIC: 01139740

**VIC MONTALBO**

310.451.8171 X230  
VMONTALBO@EPSTEEN.COM

BRE LIC: 00927723

**JACK AUSTIN**

310.451.8171 X221  
JAUSTIN@EPSTEEN.COM

BRE LIC: 02217375



# PROPERTY DETAILS

- Established community center completely restored
- Highly visible shop spaces available
- Signalized intersection
- Easy street access
- Prominent pylon and monument signage throughout
- Office and Medical influence immediate

● Join:    

# DEMOGRAPHICS

Population



Daytime Population



Avg. Household Income



	Population	Daytime Population	Avg. Household Income
<b>1 MILE</b>	19,415	5,159	\$174,634
<b>2 MILE</b>	66,435	19,708	\$175,408
<b>3 MILE</b>	170,376	75,058	\$164,268

## TRAFFIC COUNTS

<b>SPRING ST</b>	31,447 CPD
<b>PALOS VERDES AVE</b>	17,853 CPD

 **WALK SCORE**  
**78**



# SITE PLAN

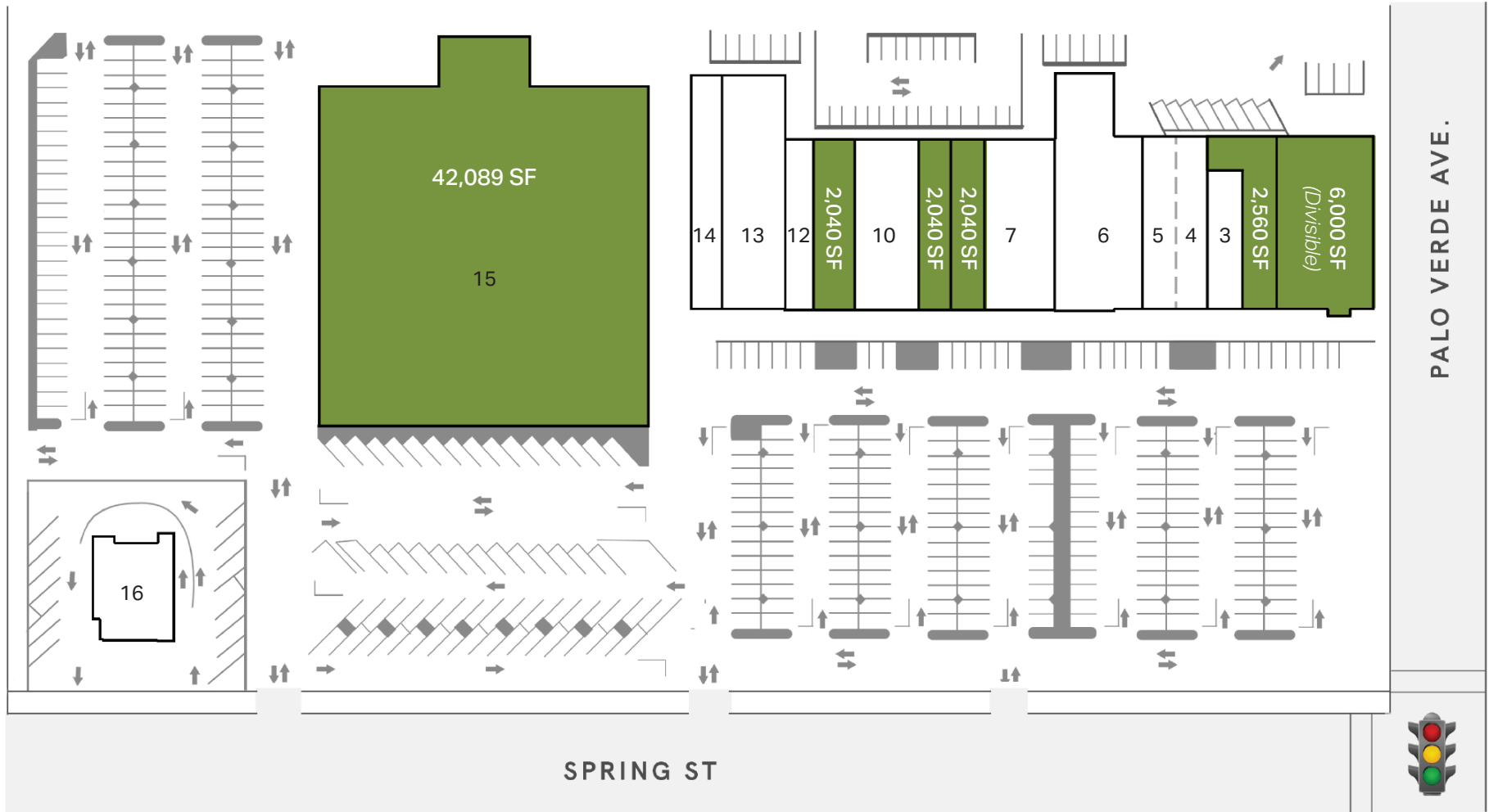

- |   |  |
|---|--|
| 1. Available   6,000 SF                           | 10. Grounds Coffee & Bakery   4,080 SF                 |
| 2. Available   2,560 SF                           | 11. Available   2,040 SF <i>Restaurant Ready Space</i> |
| 3. Subway   1,540 SF                              | 12. Bamboo Nails   2,040 SF                            |
| 4-5. Pacific Dental   2,040 SF <i>Just Leased</i> | 13. Vitamin City   6,400 SF                            |
| 6. Anytime Fitness   6,940 SF <i>Just Leased</i>  | 14. H&R Block   2,000 SF <i>Recently Renewed</i>       |
| 7. Petco Unleashed   4,640 SF                     | 15. Available (Amazon Fresh)   42,089 SF               |
| 8. Available   2,040 SF                           | 16. John's Hamburger   2,453 SF                        |
| 9. Available   2,040 SF                           |  |

**SHOPPING  
CENTER  
GLA:**

**91,552 SF**

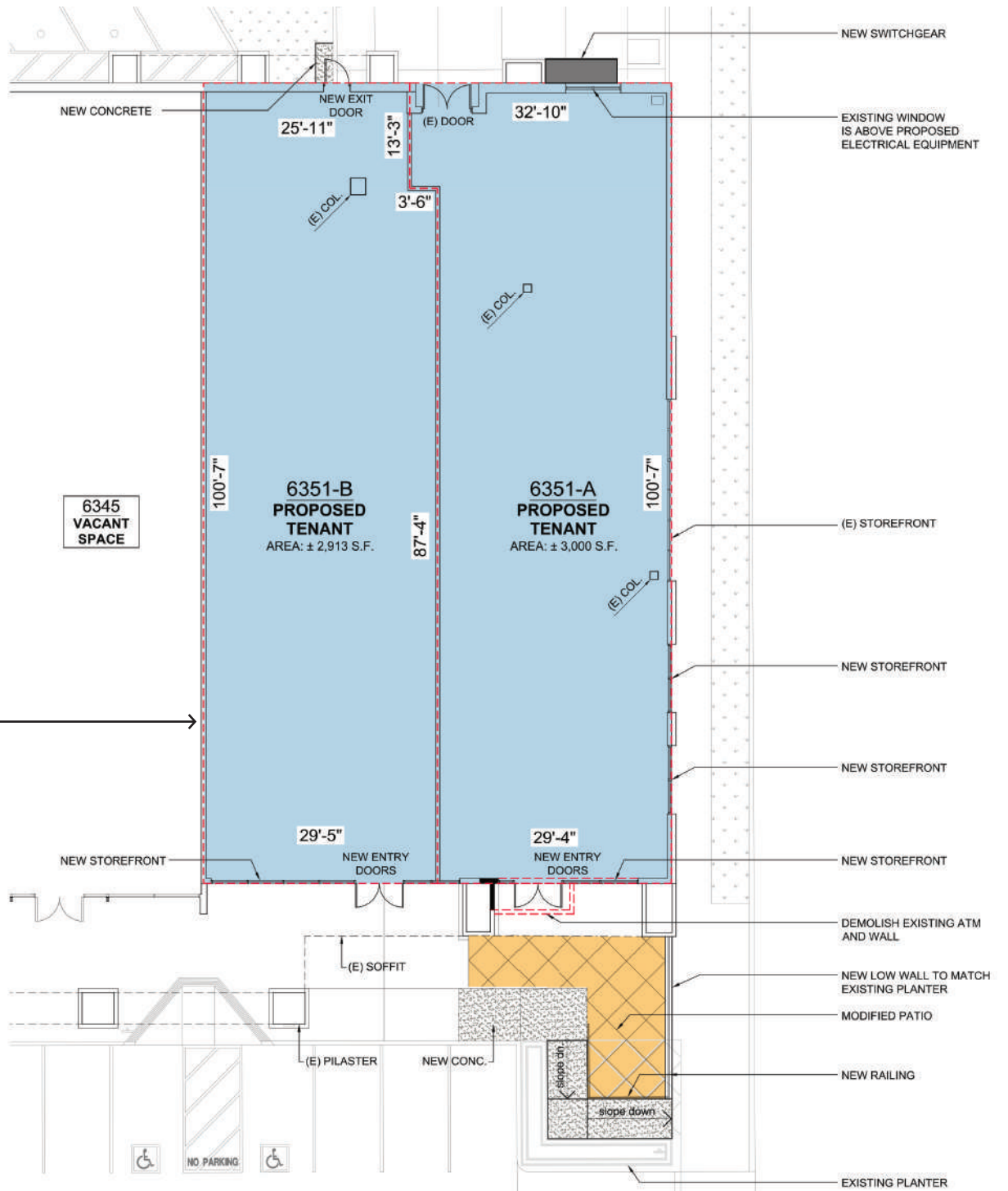
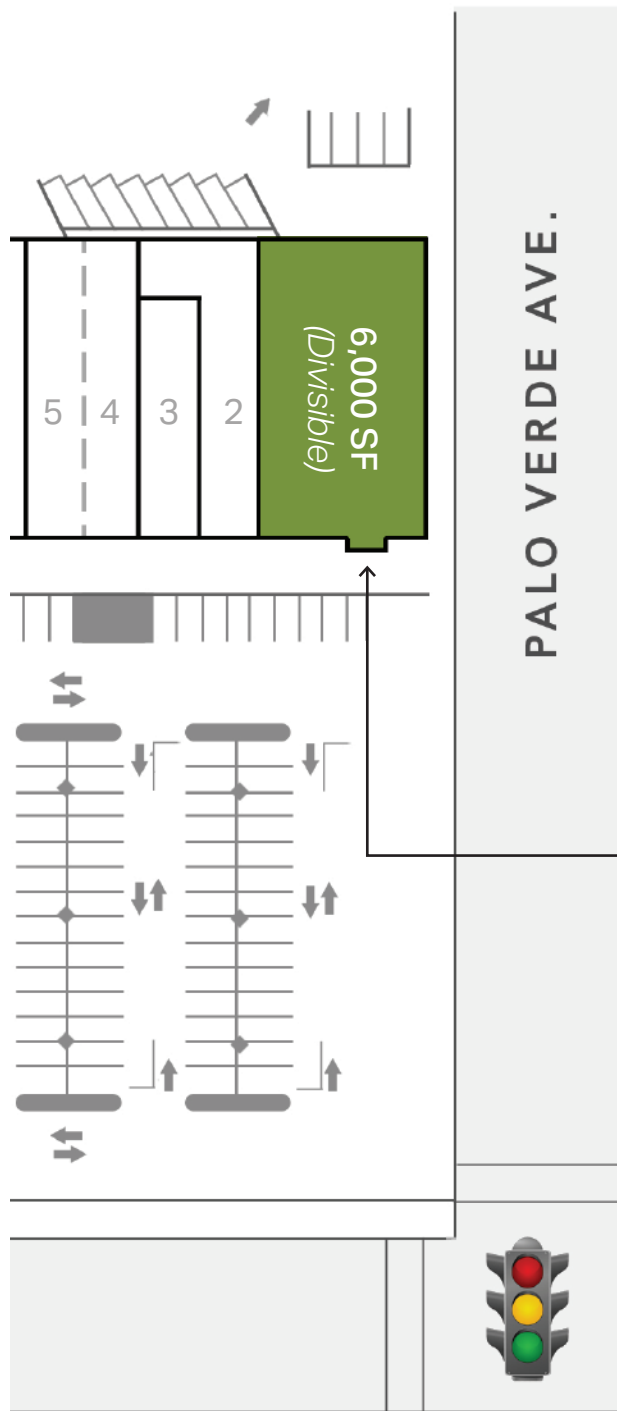

This information is deemed reliable, but not guaranteed. All information should be independently verified for its accuracy and completeness before relying upon it.

# 2-MILE RETAIL AERIAL



This information is deemed reliable, but not guaranteed. All information should be independently verified for its accuracy and completeness before relying upon it.